

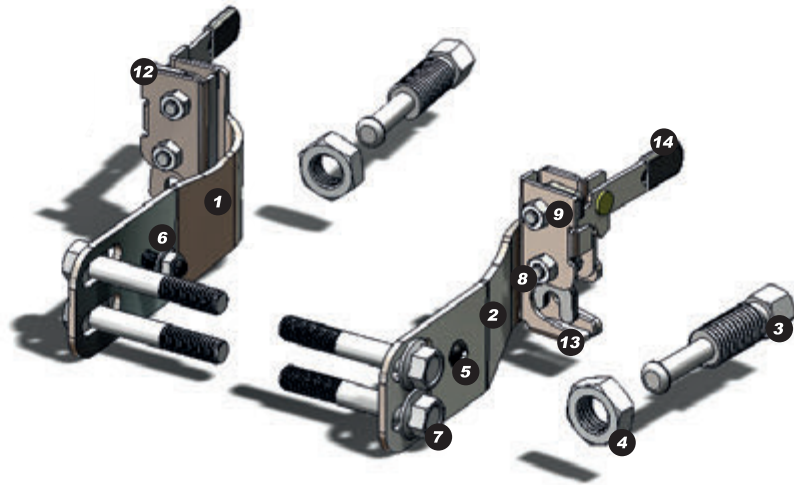

Pro Armor believes that safety should always be your **FIRST** priority, so please follow these important steps in order for your Slam Latch system to work safe and effectively.

PARTS LIST

1	PASSENGER SIDE SLAM LATCH BRACKET	1
2	DRIVER SIDE SLAM LATCH BRACKET	2
3	SLAM LATCH PIN	2
4	5/8" JAM NUT	2
5	BUTTON HEAD BOLT M6 1.00 X 25MM	2
6	NYLOC FLANGED HEX NUT M6 X 1.0	2
7	FLANGED HEX HEAD BOLT 3/8-16 X 2.25"	4
8	HEX HEAD BOLT M6 X 1.00 X 25MM	4
9	ZINC HEX NUT M6 X 1.0	4
10	.250" SPACER W .375" HOLE	2
11	.500" RUBBER GROMET HOLE PLUG	2
12	ROTARY LATCH SINGLE CATCH PASSENGER SIDE	1
13	ROTARY LATCH SINGLE CATCH DRIVER SIDE	1



⚠ WARNING

Pro Armor doors **DO NOT** guarantee safety. **YOU MUST ALWAYS WEAR THE PROPER SAFETY GEAR INCLUDING SEAT BELTS AND HELMETS.** If any door comes open at any time, you need to stop immediately and determine the cause. If you are unable to determine the cause, **DO NOT OPERATE THE VEHICLE.** Please contact your dealer or Pro Armor.

TOOL REQUIRED

14MM SOCKET & RATCHET - FOR CAGE BOLTS
14MM WRENCH - FOR CAGE BOLTS
10MM SOCKET & RATCHET - FOR SLAM LATCH BOLTS
10MM WRENCH - FOR SLAM LATCH AND BUTTON HEAD NUTS
5/8" WRENCH - FOR SLAM LATCH PIN
15/16" OR ADJUSTABLE WRENCH - FOR JAM NUT
4MM ALLEN WRENCH - FOR BUTTON HEAD BOLTS

PREPARATION AND INSTALLATION:

- [1] The Slam Latches are designed to fit between the roll cage A - Pillar and the aluminum bracket of the Pro Armor door frame.
- [2] Lay out all of the components that come in the kit and verify that everything is correct according to the parts list.
- [3] Take (12 or 13) one of the ROTARY LATCHES (8) two of the HEX HEAD BOLTS M6 X 1.00 X 25MM and (9) two ZINC HEX NUTS M6 X 1.0 installing the latch on one of the (1 or 2) SLAM LATCH BRACKETS (Driver or Passenger). Repeat process for latch in the other side
- [4] Remove and discard the two flanged head bolts that are currently installed in the Pro Armor door frame at the A-pillar of the vehicle (Driver or Passenger depending on what side you are installing.) Retain the 2 nuts.
- [5] Place the SLAM LATCH BRACKET between the door and the A-pillar loosely installing (7) two of the FLANGED HEX HEAD BOLTS 3/8-16 X 2.25" from your Slam Latch kit, re-using the nuts from the A-pillar
- [6] Take (3) one SLAM LATCH PIN and (4) one 5/8" JAM NUT then screw the nut all the way on the pin leaving it loose. (Repeat for other pin.)
- [7] Install the Slam Latch pin into the welded tab on the door until the door is able to close with out the pin interfering with the door frame bracket.
- [8] **⚠ WARNING** Close the door so that the latch pin is fully locked and engaged making sure there is no play in the release lever.
- [9] With the Slam Latch loosely installed you can now start to align the latch pin with the Slam Latch.

[For further information on Slam Latch installation instructions and warnings please visit our website WWW.PROARMOR.COM or contact customer service at 1-888-312-7667.]

Slam Latch Installation Instructions, Rev. 2 (01/06/2012)

SIDE VIEW

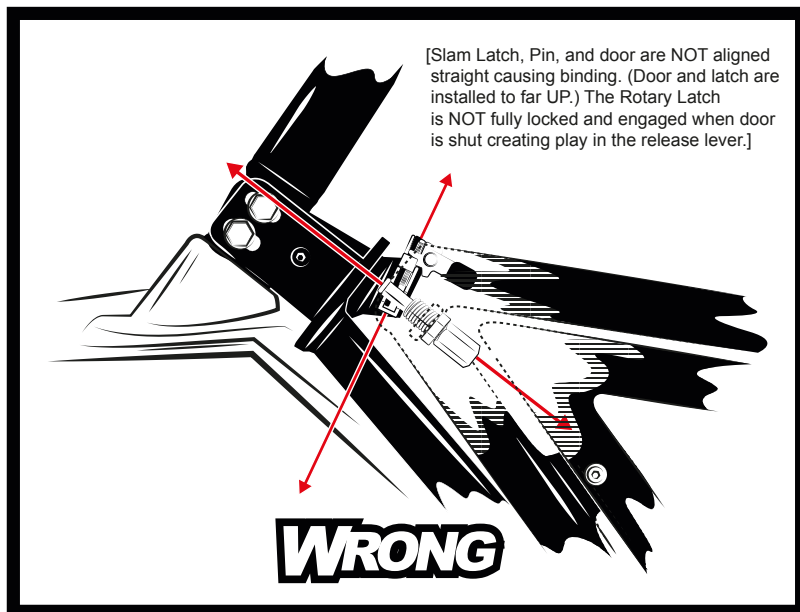
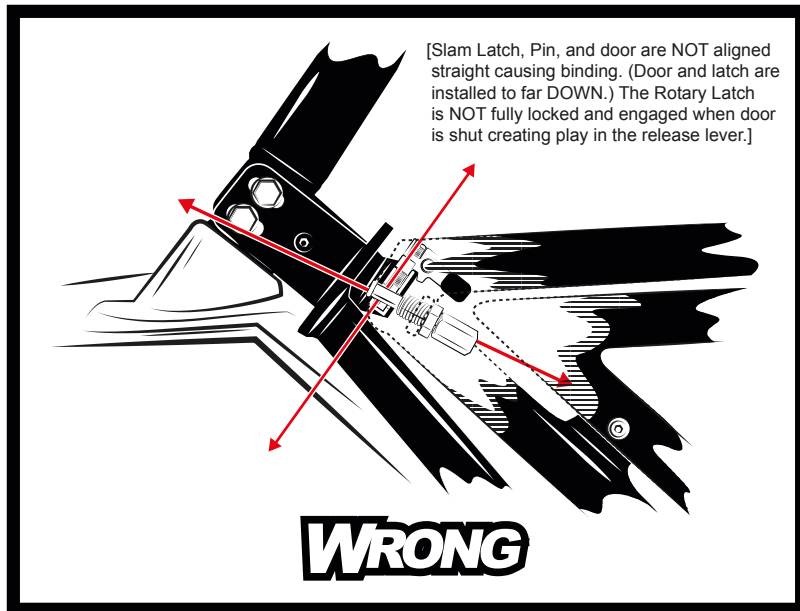
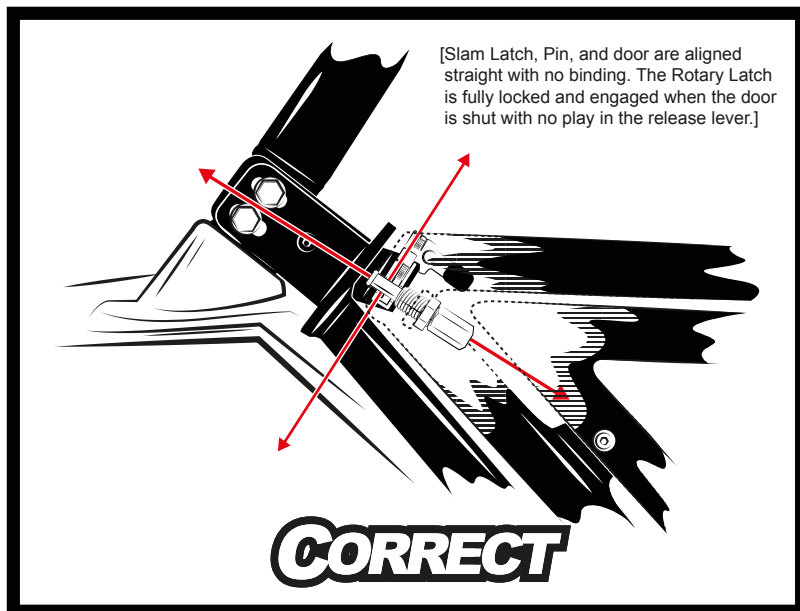

[For further information on Slam Latch installation instructions and warnings please visit our website WWW.PROARMOR.COM or contact customer service at 1-888-312-7667.]

Slam Latch Installation Instructions, Rev. 2 (01/06/2012)

! WARNING

ADJUST THE LATCH PIN BY SCREWING IT EITHER IN OR OUT UNTIL THE LATCH PIN HEAD PROTRUDES THROUGH THE SLAM LATCH BUT DOES NOT INTERFERE WITH THE DOOR FRAME OR THE SLAM LATCH ITSELF.

TOP VIEW

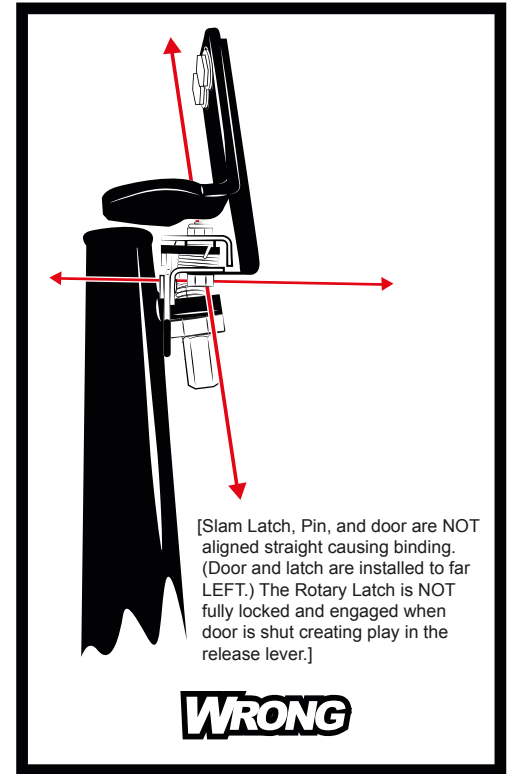
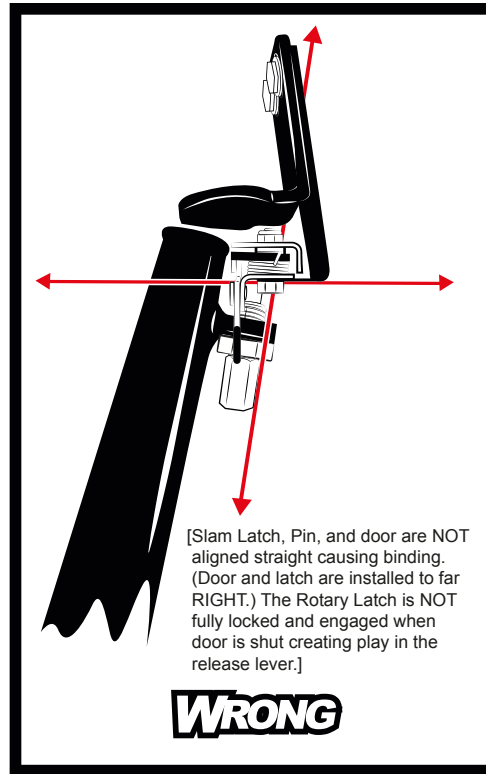
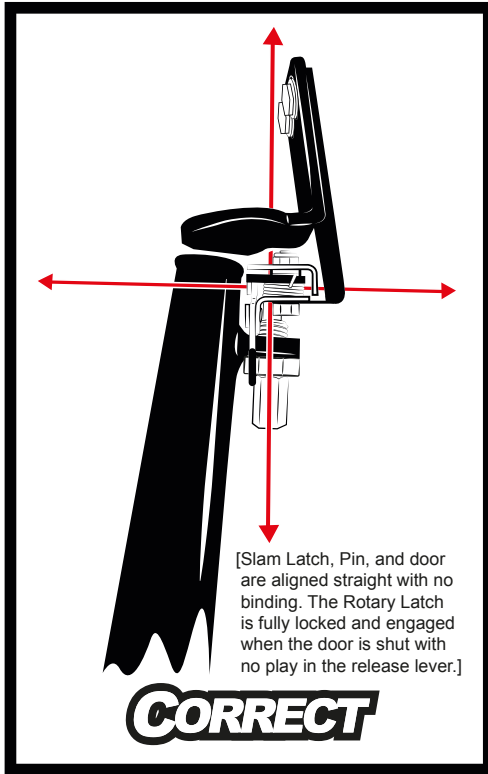

- [10] If needed move the slam latch bracket forward or backwards to align the latch pin.
- [11] With the door shut and no binding of the Slam Latch & pin begin tightening the (7) two FLANGED HEX HEAD BOLTS 3/8-16 X 2.25" at the A-pillar.
- [12] Tighten all of the hardware making sure to tighten the jam nut on the latch pin and all the hardware connecting the rotary latch to the slam latch bracket. Cycle the door open and shut to verify that the latch fully engages when the door is shut and that there is no binding. Once the final position of the bracket has been determined and the door functions properly you can drill a 1/4" hole into the aluminum door frame bracket at the A - pillar to match the hole provided in the slam latch bracket.
- [13] Once the hole is drilled take (5) one BUTTON HEAD BOLT M6 1.00 X 25MM and (6) one NYLOC FLANGED HEX NUT M6 X 1.0 installing them through the door frame bracket and the Slam Latch bracket.

**** A video of Pro Armor's installation instructions can be found at our website (www.proarmor.com) or one of our skilled technicians (1-888-312-7667) will be happy to assist you if you have any questions. ****

[For further information on Slam Latch installation instructions and warnings please visit our website WWW.PROARMOR.COM or contact customer service at 1-888-312-7667.]

Slam Latch Installation Instructions, Rev. 2 (01/06/2012)



- Check to be sure that the doors and vehicle frame are correctly aligned. If the doors and frame are not aligned properly, that latch pin and Slam Latch body may not be aligned and the latch pin may not fully engage and/or the door may not close completely. Inspect the doors and check to see that the latch pin and Slam Latch body are aligned properly and that the latch pin fully engages when the door shuts completely before each use.
- All screws and bolts should be tightened. Do not over-torque or bolts and screws may weaken or break.
- Inspect the Slam Latch, pin and parts to see that they are not cracked, bent, corroded, or otherwise damaged. Inspect the pin and latch to check that they are both fully operational.
- Have an authorized dealer or trained technician inspect the door alignment and Slam Latch after a collision or in the event of any damage.
- Always wear your seat harness during vehicle use. The doors are not designed to keep you inside the vehicle during collisions, sharp or unexpected movements, inclines, declines, rollovers or rough or extreme riding conditions.
- Off-road riding requires skill and can be dangerous. Always wears all of your protective gear, including helmet, seat harness, protective clothing and other safety items.
- Failure to follow all of these instructions and warnings may result in serious injury or death.