

POLARIS® RZR® PHASE 3 POWERSPORTS AUDIO KIT

pg 2

Disassembly, Wire and
Amplifier Plate Installation

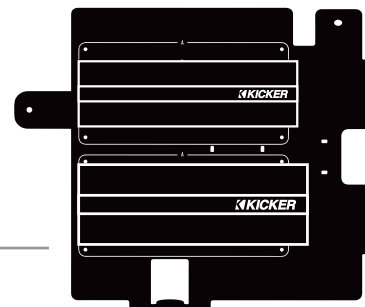

pg 9

Glovebox Subwoofer
Installation

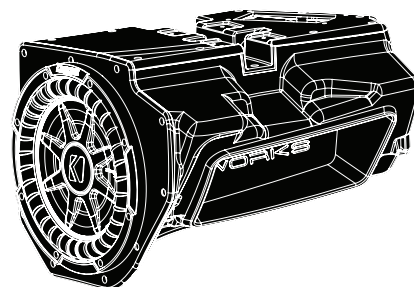

pg 13

Kick Panel Speakers
Installation

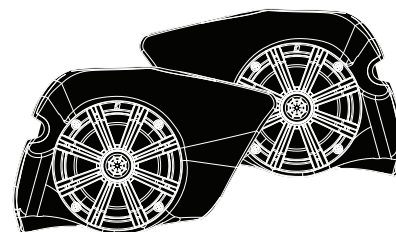

pg 25

MRB3 and Dash Kit
Installation





RZ3-3K

Polaris RZR XP 1000 & 900

Kicker 3 Speaker Audio Kit

WARRANTY INFORMATION:

All SSV Works enclosures are covered by a limited lifetime warranty against defects in material or workmanship. All SSV Works Electronics are covered by a limited 1 year warranty against defects in material or workmanship. All Kicker Speakers are covered by a limited 1 year warranty against defects in material or workmanship. All Kicker Amplifiers are covered by a limited 2 year warranty against defects in material or workmanship. Labor for replacement of defective components is not covered. Contact SSV Works for further warranty information.



Please read and understand these instructions completely before installation to avoid possible injury, or damage to the accessory or vehicle.

TOOLS NEEDED FOR INSTALLATION

- | | | | | |
|---|--------------------------------|--------------------------------|------------------|--------------------|
| - T30 & T40 Torx Socket | - 4mm & 5mm Allen Wrench | - Drill with 1/8", 1/4" & 1/2" | - Wire Crimpers | - Scribe or Marker |
| - 10mm and 5.5mm Socket & Ratchet or Wrench | - #2 & #3 Phillips Screwdriver | Drill bits | - Wire Strippers | - Utility Knife |
| | | - Panel removal tool | | |

PARTS LIST IMAGES



1. Amp Power Wire



2. Front B-H1149 Speaker Wire



3. Rear B-H1151 Speaker Expansion



4. MRB3 Power & Ground Connector



5. Direct-fit Amp Plate with pre-tuned Amp and MRB3 Brain



6. M6 x 1.0 Screws x 1



7. M6 Washer x 1



8. Zip Ties x 5



9. Fuse Holder with 40A Fuse



10. Battery Terminal Cable

PANELS AND DASH DISASSEMBLY



A. Remove all seats by releasing the handle behind each seat, push forward slightly while lifting up.



B. Disconnect the negative battery cable from the battery.



C. Remove hood by turning locking pins and lifting up.

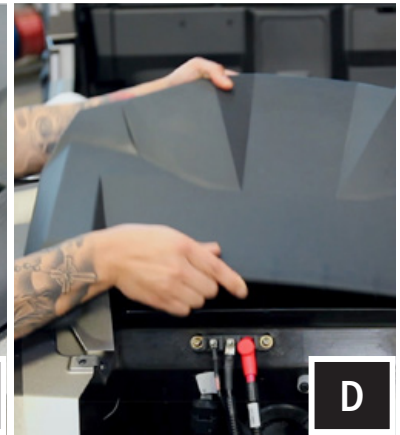
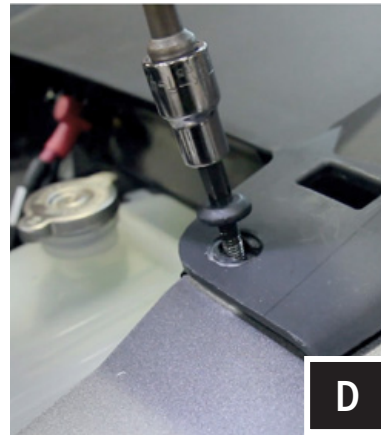

D. Remove center dash by unscrewing the 2 T-30 Torx screws and push center dash forward to unclip.



E. Disconnect all harness connectors attached to the center dash panel.



F. Un-pin and pull to remove the passenger side safely handle.

PANELS AND DASH DISASSEMBLY

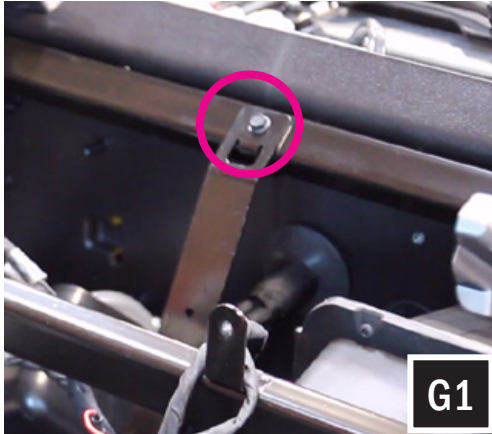

G. Remove the factory dash pocket by first extracting the 10mm bolt on the dash frame (G1). Then pull out the dash pocket with bracket attached (G2) - NOTE this bracket will no longer be used for any part of this installation. Save this screw as it will be use later during the amp plate installation. Extract (2) screws securing the sub dash (G3). Unsnap and remove.



H. Remove all of the center console push pins and T-30 Torx screws. For 4-seat models, disconnect the harness attached to the 12v accessory socket.



I. Remove glovebox by removing (2) 10mm screws.

RUNNING AMP POWER CABLE AND REAR SPEAKER WIRE



A. Unwrap the tape and pull the rubber wire grommet out of the firewall.



B. Pull the MRB3 POWER and GROUND wires through the rubber grommet and feed through the hole in the firewall to the power strip located on the opposite side of the firewall.

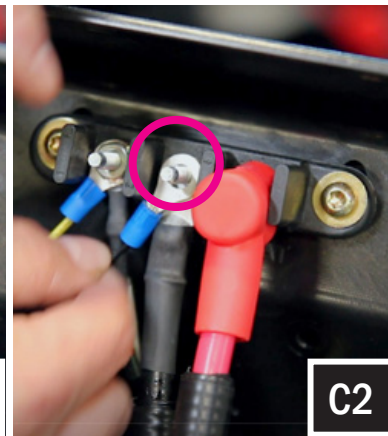
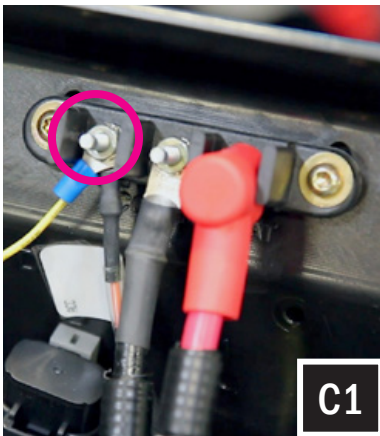

C. From under the hood, against the top firewall, unscrew the nut on the first position terminal (12v accessory) and attach the yellow POWER wire. Refasten on the nut (C1). Then unscrew the nut on the second position terminal and attach the black GROUND wire. Re-screw on the nut (C2).



NOTE Some RZR models come with the ground “GND” terminal not connected as shown. If you do not have a factory wiring going to this terminal, add a ground wire from the “GND” terminal to the frame before connecting the wires. We recommend removing the paint to bare metal, using a star washer, and repainting over the connection.



D. Feed the connector end of the Amp power wire through the center console to the other side of the firewall (D1). Then feed the power wire through the grommet hole (D2) and through the rubber grommet with the rest of the vehicle's wiring and cables (D3). Do the same for the 2nd Amp power & rear speaker wire.

RUNNING AMP POWER CABLE AND REAR SPEAKER WIRE

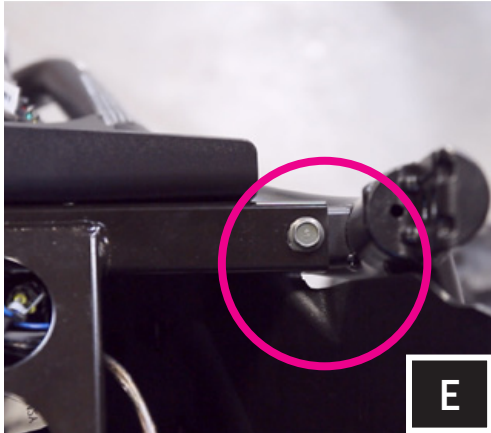

E. Route the front speaker wire through the opening where the firewall and roll cage bar meet on both the driver and passenger side. Leave these wires loose until the front speaker pods are to be installed.

AMP PLATE INSTALLATION

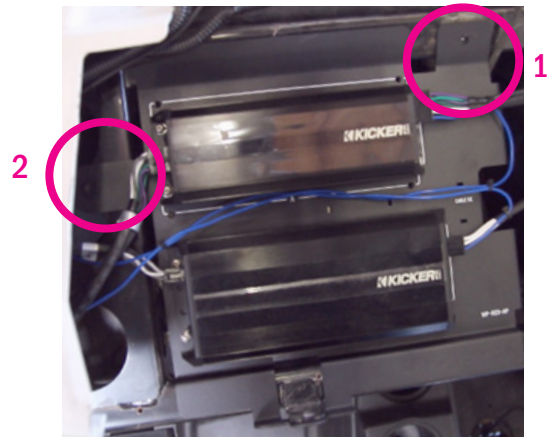
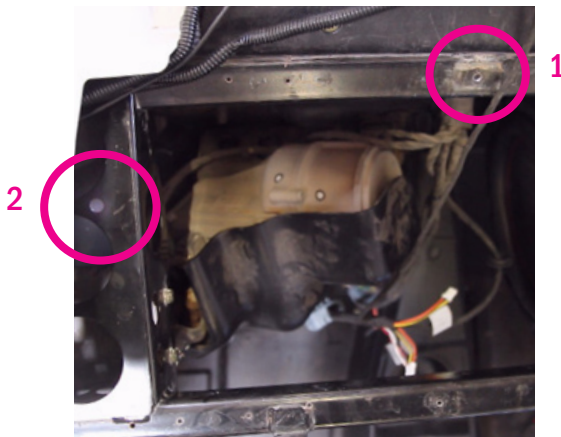

Place the pre-installed amp plate with MRB3 Brain on the frame of the dash and line up the hole on the top of the amp plate to the factory hole where the pocket bracket was previously installed (1). Loosely screw in the factory 10mm screw in this hole location.

Next loosely screw in the M6 screw with washer from underneath the steering column into the amp plate (2).

Lastly hand tighten both screws.

THIS CONCLUDES THE DISASSEMBLY AND RUNNING OF THE POWER AND SPEAKER WIRE. NOW REFER TO INSTRUCTION 1 - INSTALLATION OF THE GLOVEBOX SUBWOOFER ENCLOSURE.



1

RZR XP1000 & 2015+ RZR900 Kicker 10" Glove Box Subwoofer Enclosure

WARRANTY INFORMATION:

All SSV Works enclosures are covered by a limited lifetime warranty against defects in material or workmanship. All SSV Works Electronics are covered by a limited 1 year warranty against defects in material or workmanship. All Kicker Speakers are covered by a limited 1 year warranty against defects in material or workmanship. All Kicker Amplifiers are covered by a limited 2 year warranty against defects in material or workmanship. Labor for replacement of defective components is not covered. Contact SSV Works for further warranty information.



Please read and understand these instructions completely before installation to avoid possible injury, or damage to the accessory or vehicle.

TOOLS NEEDED FOR INSTALLATION

- Wire Crimpers
- Wire Strippers
- 10mm Socket or Wrench
- Drill with 1/8" and 1/4" Drill bits
- T-30 Torx Driver
- T-40 Torx Driver
- #3 Phillips Screwdriver
- #2 Phillips Screwdriver
- Panel removal tool

PARTS LIST IMAGES



1. WP-RZ3GBS10 Enclosure
(door not included)



2. M6 x 16mm Screws x 11
(Long)



3. M6 x 8mm Screws x 2
(Short)



4. M6 Washers x 13



5. Flat Mounting
Brackets x 2



6. "L" Bracket x 1



7. Glove Box Door
Bracket x 1



8. H1173 Audio Cable

INSTALLATION NOTES

Removal of the passenger fender is not required (Step 3); however it will make the installation and alignment of the RZ3-GB10K easier.



A. Remove the ten T40 Torx bolts that secure the 2 piece fender. Note: there is one screw inside the fender well. Remove the two additional screws from the striker plate, slide fender up the cage rail and secure

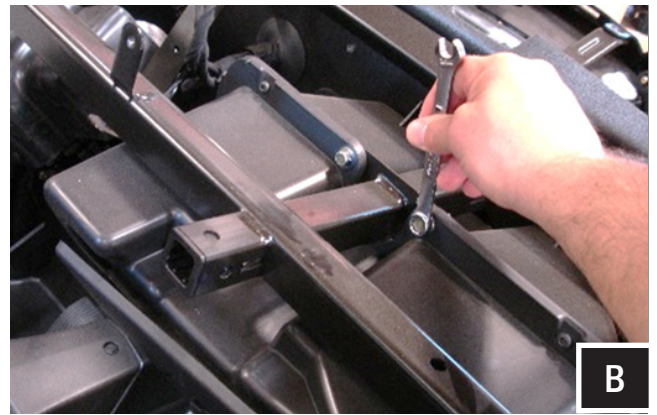

B. Remove the two 10mm bolts that secure factory glove box and remove the factory glove box

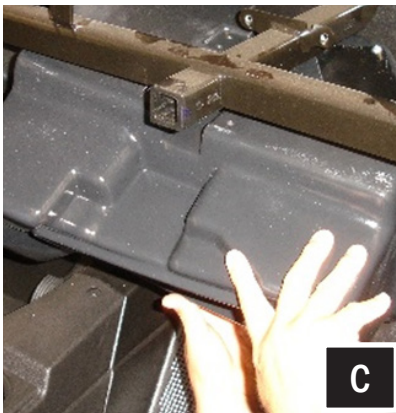

C. Lift the enclosure into place and align the top channel in the grab handle bar. While holding the enclosure in place, loosely attached the flat brackets to the top of the enclosure using the long screws provided.

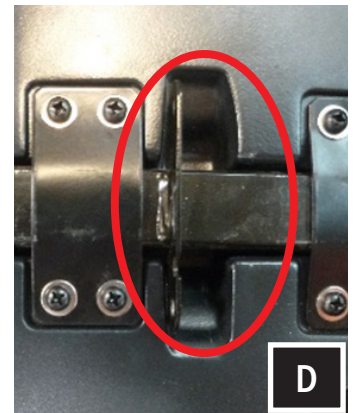
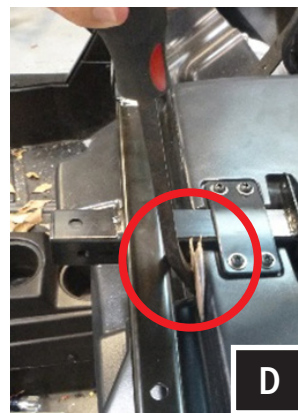

D. To properly align the box, slide the box firmly toward the front of the vehicle. It should sit approximately 1/4" from the factory glove box mount. If not properly installed, the kick pod and dash panel will not align in place.



E. While applying pressure to keep the enclosure secure against the front wall, tighten the top brackets, as they tighten they will bend slightly to add pressure and avoid any vibration, now tighten the lower L bracket to the enclosure



F. Loosely install the bottom L bracket, align the mounting hole with the factory bung and secure with one of the long screws provided (you will tighten the bracket to the enclosure and factory bung AFTER step J)

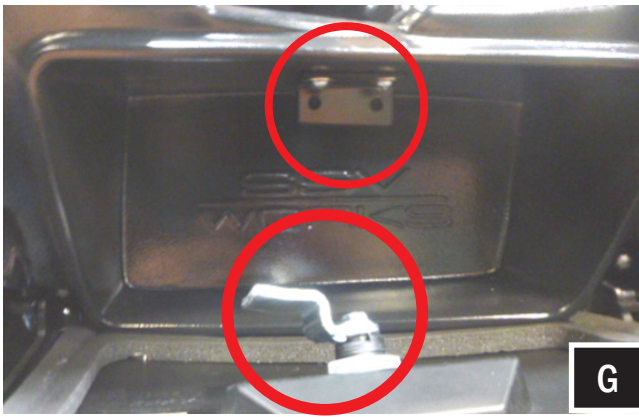

G. For 2015-up model year vehicles, install the supplied bracket using the short screws provided and adjust forward or back so glove box latch closes tight



H. For 2014 model year vehicles remove the factory glove box door latch. Mount the latch to the supplied bracket and secure to the enclosure using the short screws provided



I. Route the speaker wire away from any moving parts and any sharp metal, then connect to the amplifier.



J. Attach the factory glovebox door



2

RZR XP1000 & 2015+ RZR900 Kicker 6.5" Speaker Front Kick Panels

WARRANTY INFORMATION:

All SSV Works enclosures are covered by a limited lifetime warranty against defects in material or workmanship. All SSV Works Electronics are covered by a limited 1 year warranty against defects in material or workmanship. All Kicker Speakers are covered by a limited 1 year warranty against defects in material or workmanship. All Kicker Amplifiers are covered by a limited 2 year warranty against defects in material or workmanship. Labor for replacement of defective components is not covered. Contact SSV Works for further warranty information.



Please read and understand these instructions completely before installation to avoid possible injury, or damage to the accessory or vehicle.

TOOLS NEEDED FOR INSTALLATION

- Wire Crimpers
- Wire Strippers
- T-30 Torx Driver
- Drill with 1/8", 1/4" and 1/2" Drill bit
- #2 Phillips Screwdriver
- Scribe or Marker
- Utility Knife

PARTS LIST IMAGES



1. RZ3-F65K Enclosures
(1 pair)



2. M6 x 16mm Screws x 6



3. M6 Washers x 6

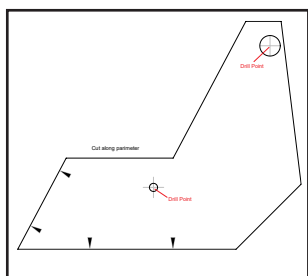

4. Driver Side Inside Template

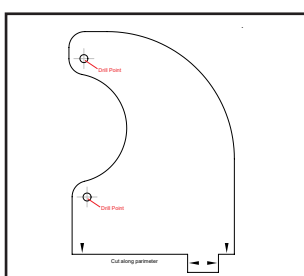

5. Driver Side Outside Template

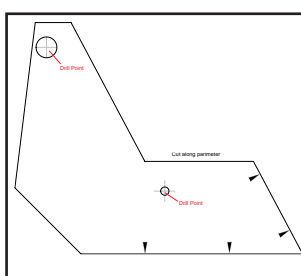

6. Passenger Side Inside
Template

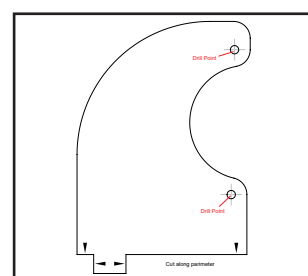

7. Passenger Side
Outside Template



A. Using the utility knife or another cutting tool cut off the two plastic factory nubs in the foot well, cut these as smooth as you can to the panel.

NOTE: If pod does not come pre-installed with speaker, do not use provided paper templates. Use the pod mounting holes as your drill template. Hold the pod in position and mark the drill holes through the empty pod using a scribe tool. All pilot holes will be drilled from the inside footwell.



B. Cut out the INSIDE template (Driver/Passenger) along the cut line. Position the template on the inside footwell making sure to square up the template along the factory panel as shown in image B1 and B2. Using a scribing tool, mark the center of the 2 drill points illustrated on the template as shown in B3 and B4.



C. Drill a pilot hole at the places just marked with a 1/8" drill bit. Then follow up by using a 1/4" drill bit in the lower pilot hole (for mounting the pod) and a 1/2" drill bit in the upper pilot hole (for speaker cable).

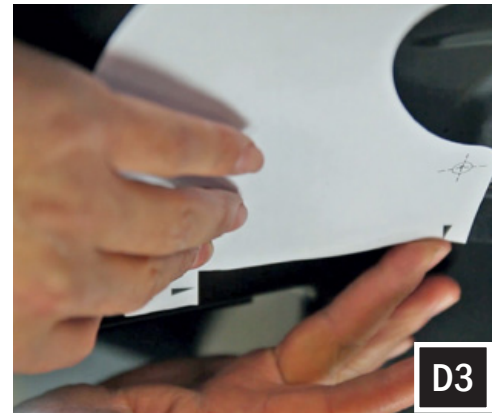
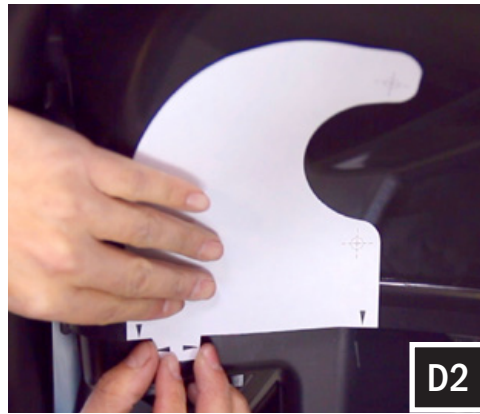
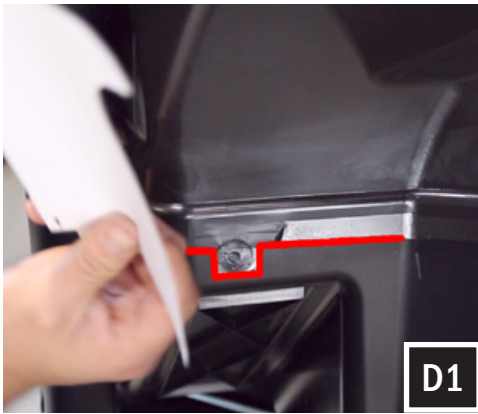

D. Cut out the OUTSIDE template (Driver/Passenger) along the cut line. Position the template on the outside footwell. Make sure the bottom of the template lines up along the bottom edge and tab of the factory panel as shown in figure D1-D3. Using a scribing tool, mark the center of the 2 drill points illustrated on the template as shown in D4 and D5. When marking these holes, make sure the template is flush against the factory panel.

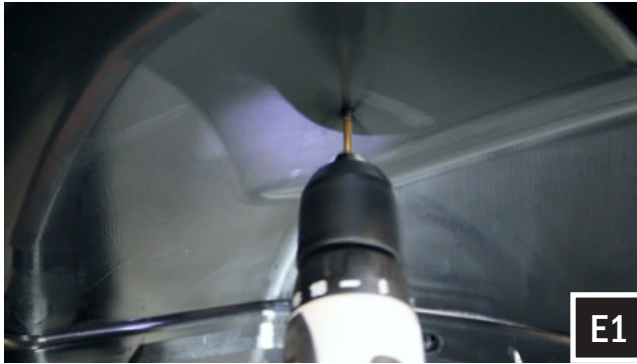

E1

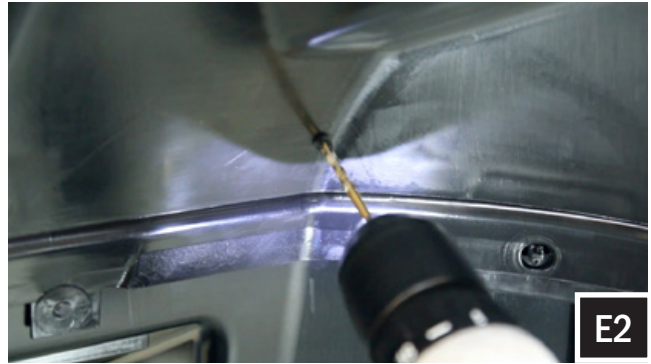

E2

E. Drill a pilot hole at the places just marked with a 1/8" drill bit. Then follow up by using a 1/4" drill bit for both pilot holes (for mounting the pod).



F

F. Route the speaker cable attached to the pod through the inside footwell 1/2" hole made in Step D.



G

G. Position the speaker pod in place and line up with drilled mounting holes



H



H

H. With the provided M6 screws and washers, loosely mount the pod through the 3 holes previously drilled. Once all screws have been inserted into the pod, hand tighten all 3 screws.



I

I. Connect the B-H1149 cable to the speaker pods and zip tie all cables to the frame



J

J. Connect the speaker harness to the amplifier

RZ3-F65
2017 Polaris RZR Kick Pod, Cut Template

Driver Outside Template

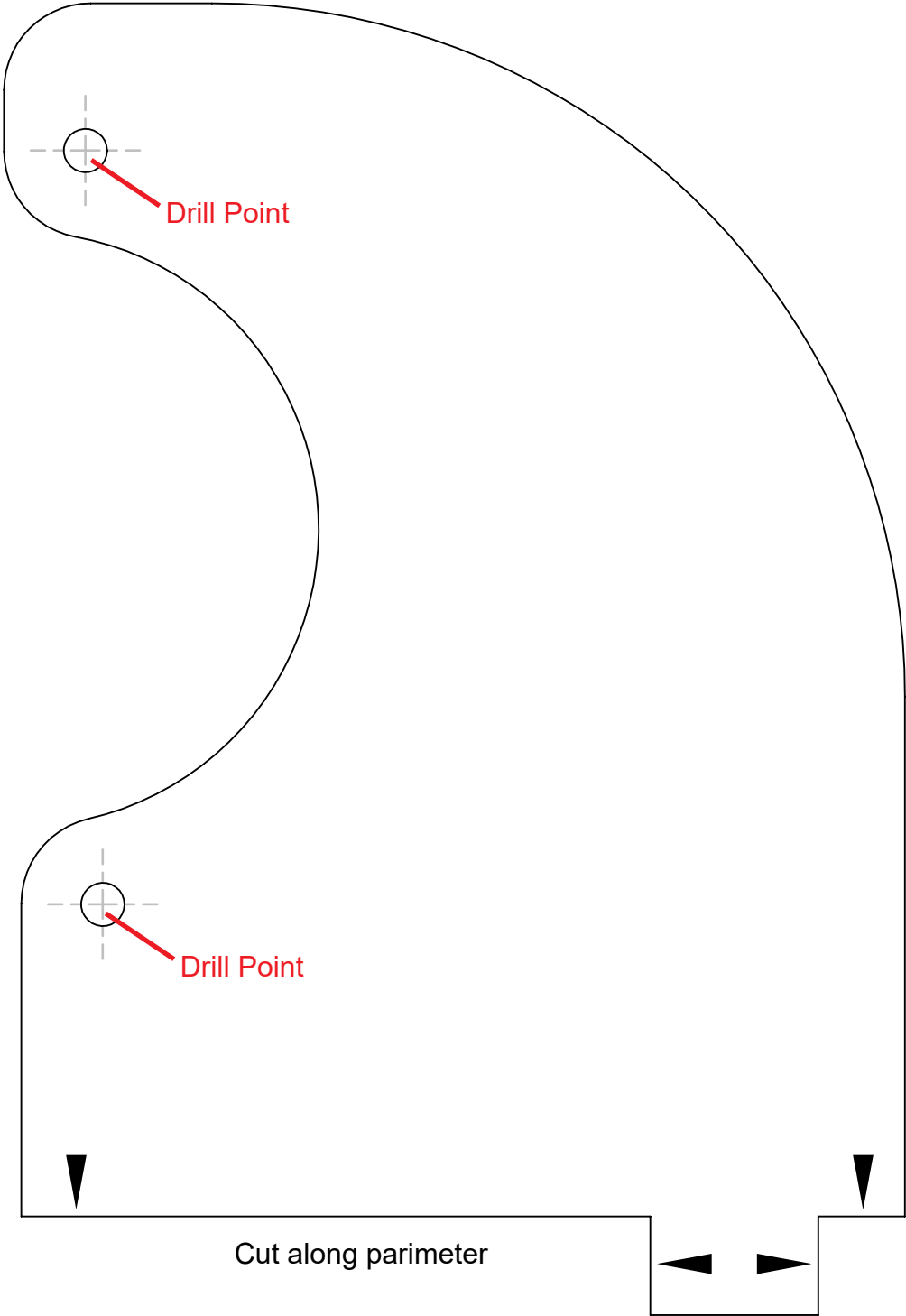

2017 Polaris RZR Kick Pod, Cut Template

Passenger Inside Template

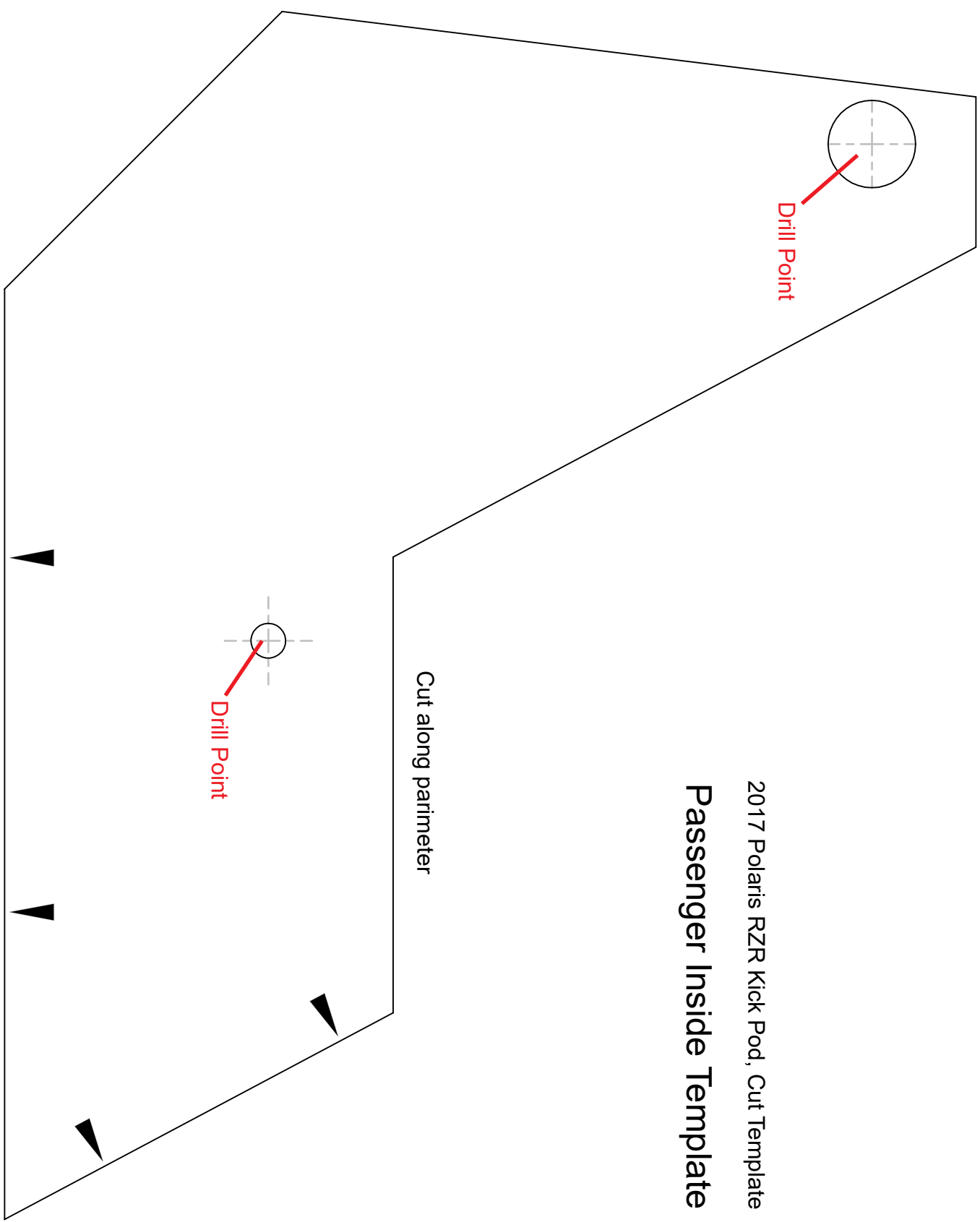

2017 Polaris RZR Kick Pod, Cut Template

Passenger Outside Template

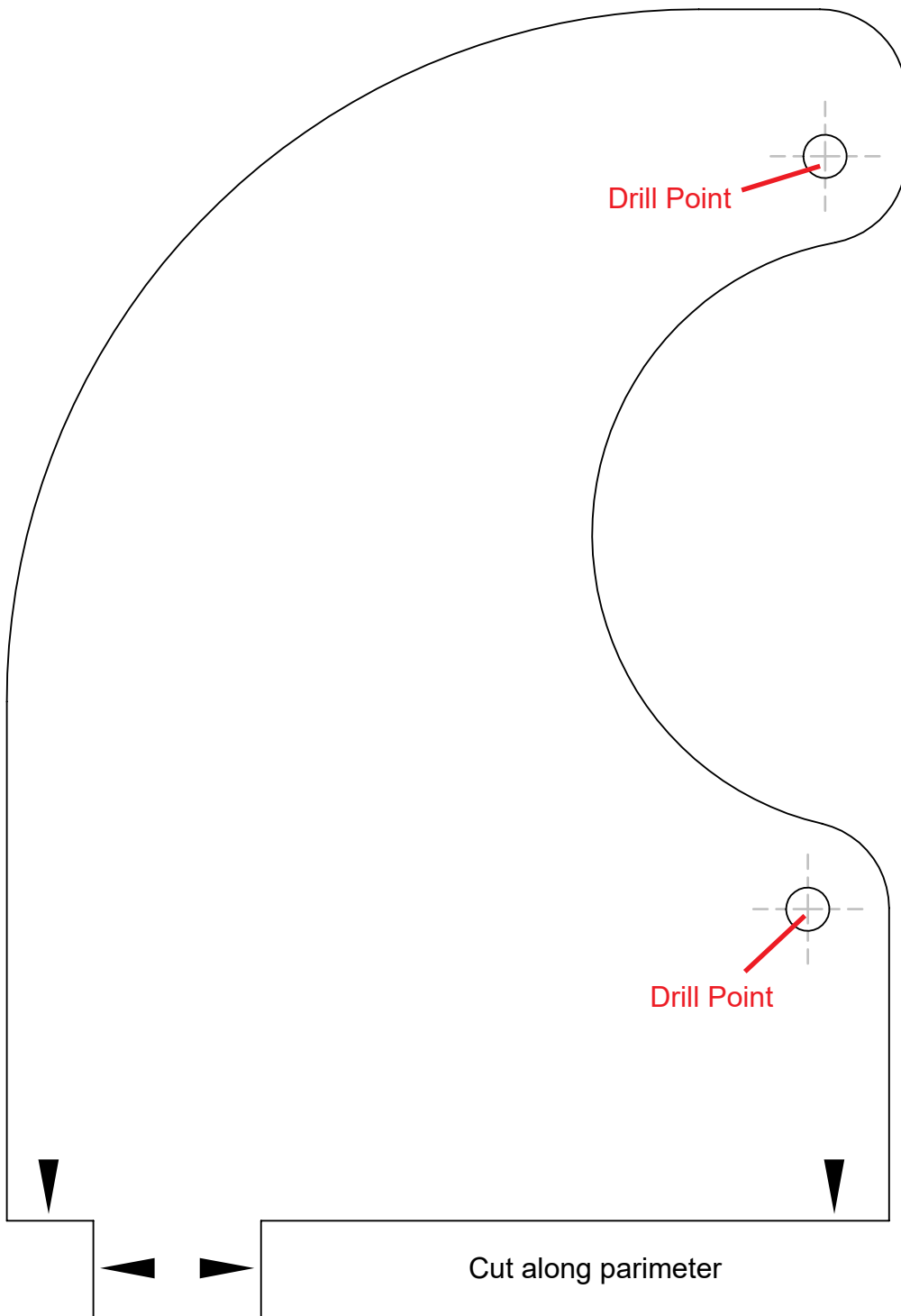

2017 Polaris RZR Kick Pod, Cut Template

Driver Inside Template

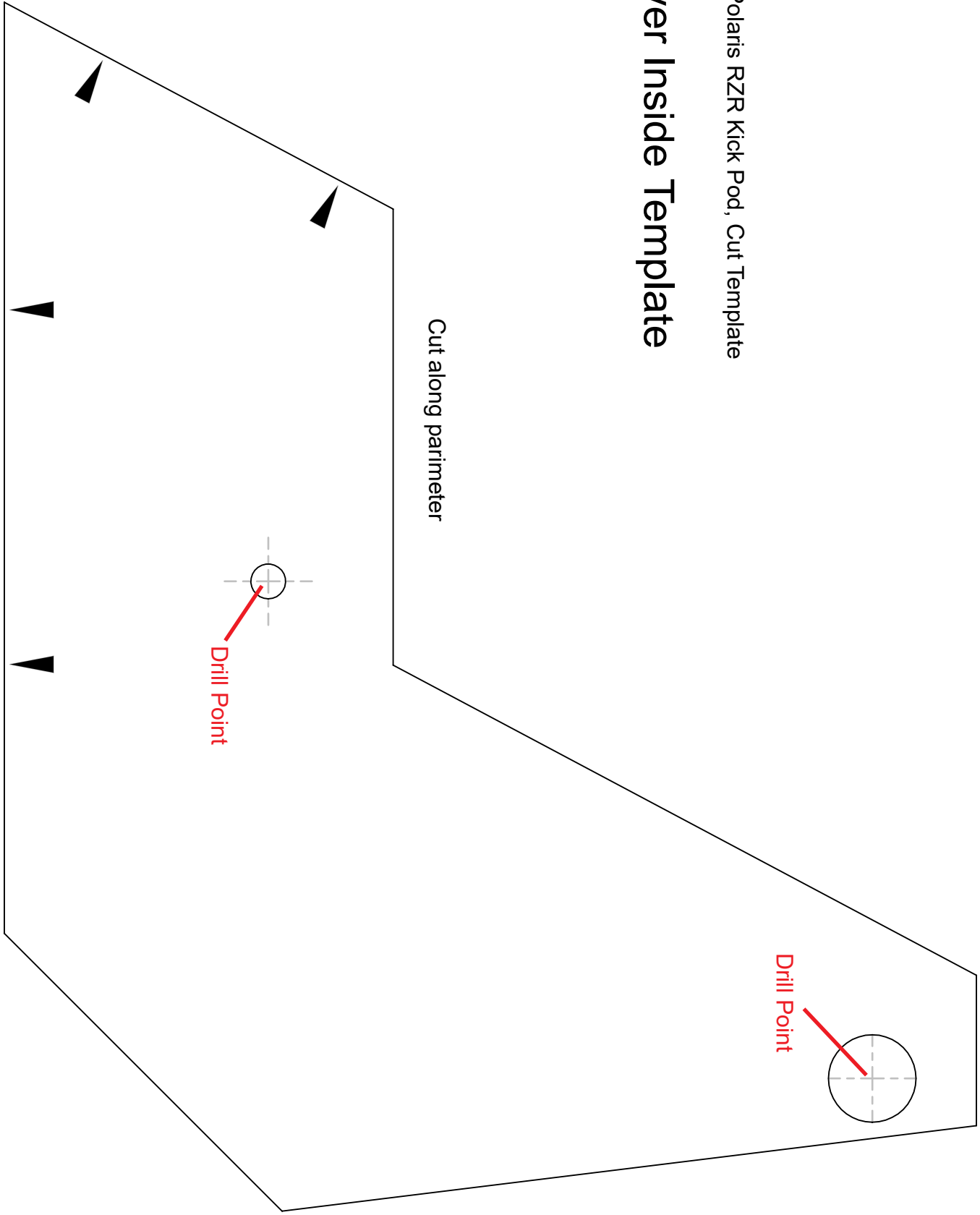



3

Polaris RZR XP 1000 & 900 Dash Kit for MRB3

WARRANTY INFORMATION:

All SSV Works enclosures are covered by a limited lifetime warranty against defects in material or workmanship. All SSV Works Electronics are covered by a limited 1 year warranty against defects in material or workmanship. All Kicker Speakers are covered by a limited 1 year warranty against defects in material or workmanship. All Kicker Amplifiers are covered by a limited 2 year warranty against defects in material or workmanship. Labor for replacement of defective components is not covered. Contact SSV Works for further warranty information.



Please read and understand these instructions completely before installation to avoid possible injury, or damage to the accessory or vehicle.

TOOLS NEEDED FOR INSTALLATION

- #2 Phillips Screw Driver
- 10mm Socket & Ratchet
- T40 Torx Socket
- 5.5mm Socket & Ratchet

PARTS LIST

- | | |
|-------------------------|-----------------------------|
| 1. RZ3 Dash Panel x1 | 4. M3 Hex Nut x2 |
| 2. Mounting Brackets x2 | 5. M3 Washer x2 |
| 3. M3 Screw x6 | 6. Blank Rocker Switches x4 |

PARTS LIST IMAGES

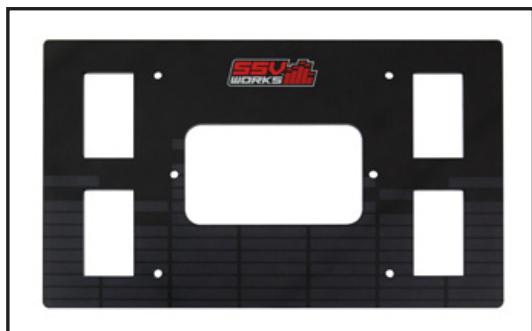

1. RZ3-DM3 Base Plate



2. Mounting Brackets



3. M3 Screw x6



4. M3 Hex Nuts x 2

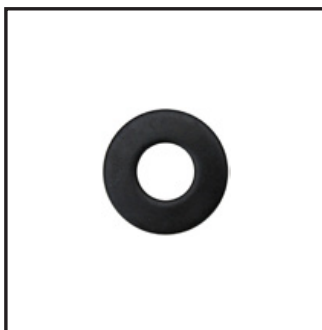

5. M3 Washers x 2



5. Blank Rocker Switches x4

INSTALLATION NOTES

For instructions regarding the MRB3 black box, refer to the MRB3 manual.

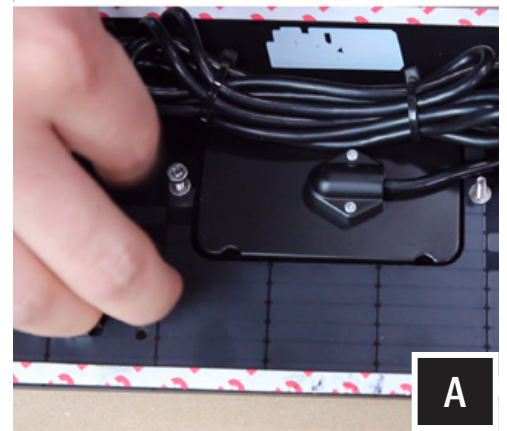
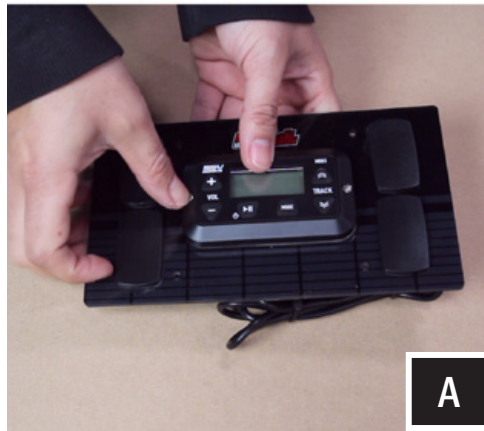
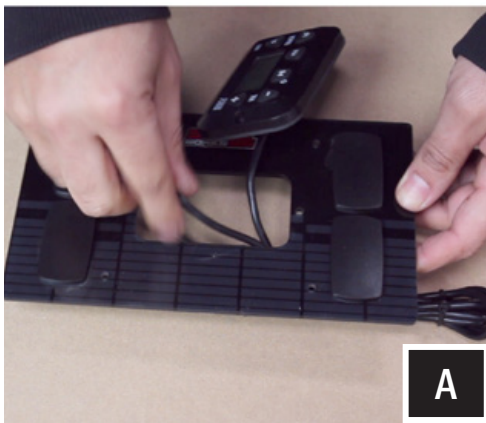

A. Take the MRB3 Remote and pass the din cable through the dash kit panel. Once MRB3 remote is laying flat on the dash panel pass (2) M3 Screws through the remote and kit panel. Flip the kit around and use (2) M3 washers and (2) M3 Nuts to secure the MRB3 down into position.

Do not over tighten the nuts, this can cause damage to the dash kit panel.

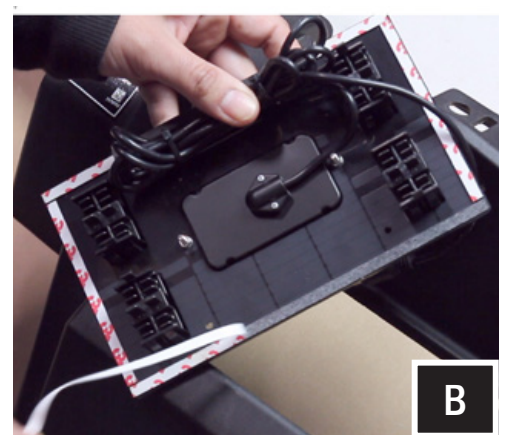
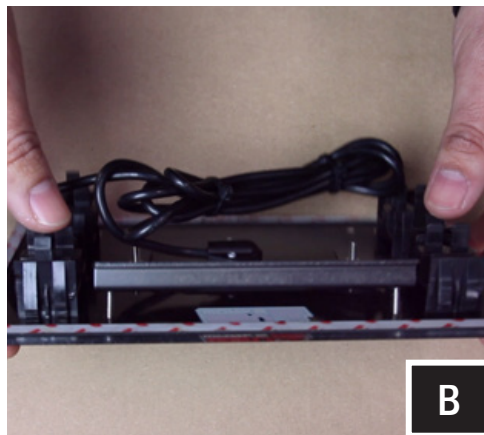

B. Loosley assemble the top mounting bracket to the dash kit panel using (2) M3 Screws. Peel off the double sided stick from the back of the dash kit panel.



C. Hook the top bracket that is mounted to the kit panel behind the dash. Lay the panel flat and firmly press down along the outside edges to ensure double sided stick tape has stuck to the dash surface. Fully tighten the top bracket. Using (2) M3 screws secure the bottom bracket to the dash panel. **Tighten the bracket just enough to firmly hold it in place, but do not over-tighten.**



D. The installation of the dash kit panel is complete. At this point you may want to install the USB/AUX input before re-installing the dash panel. Refer to Instruction 5.

If you are not installing the USB/AUX input , re-assemble the dash. Refer to the MRB3 manual for wiring instructions.



4

Polaris RZR XP 1000 & 900 USB/AUX Input Port



A. Unscrew and remove the plastic nut from the port. Make sure to open the fuse holder and remove the fuse so the nut will fit through it. Crimp on the provided ring terminals on the ends of the (Red) Power and (Black) Ground wire.



B. Make sure all harness connectors are unplugged from the dash panel. Push out the factory 12v port.



C. Feed in the wires and cable through the factory 12v hole. Keep the fuse holder open and empty until it has passed through the hole.



D. Feed the plastic nut back through the wires and cables and screw back onto the port. Hand tighten only. Replace fuse and close fuse holder.



E. Connect the AUX-in connector to the MRB3 brain.

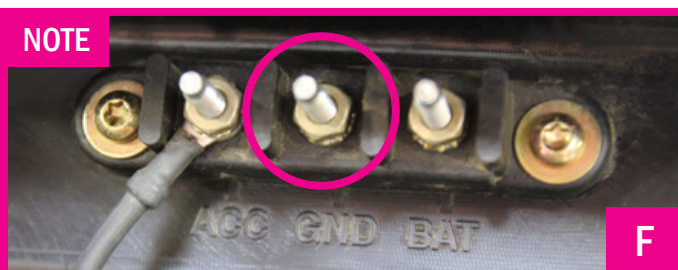

F. Some RZR models come with the ground "GND" terminal not connected as shown. If you do not have a factory wiring going to this terminal, add a ground wire from the "GND" terminal to the frame before connecting the wires. We recommend removing the paint to bare metal, using a star washer, and repainting over the connection.



G. Run the (RED) Power and (BLACK) Ground wire of the USB/Aux input port to the Bus Bar. Unscrew the nut on the first position terminal (accessory) and attach the (RED) Power wire. Re-screw on the nut. Then unscrew the nut on the second position terminal and attach the (BLACK) Ground wire. Re-screw on the nut.

CONNECTING POWER & GROUND CABLE TO BATTERY

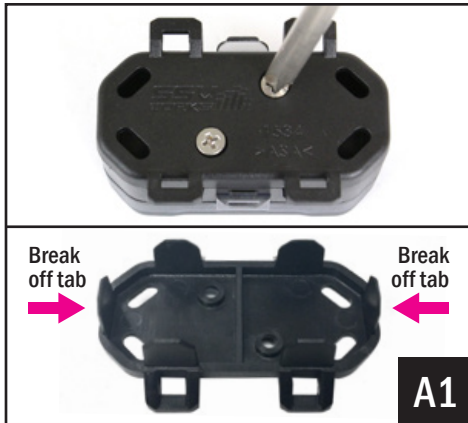

A1. Remove the bottom cover of the fuse holder by extracting the 2 screws. Break off the right and left side tabs on the bottom cover.

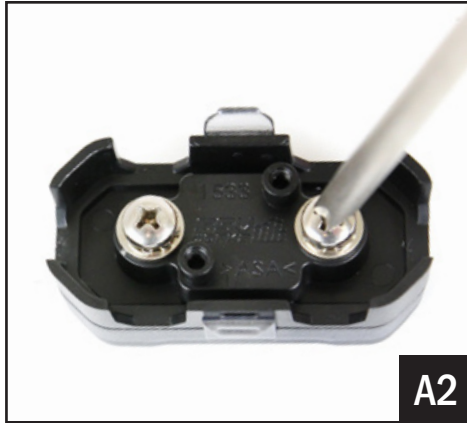

A2. Extract both fuse holder screws.

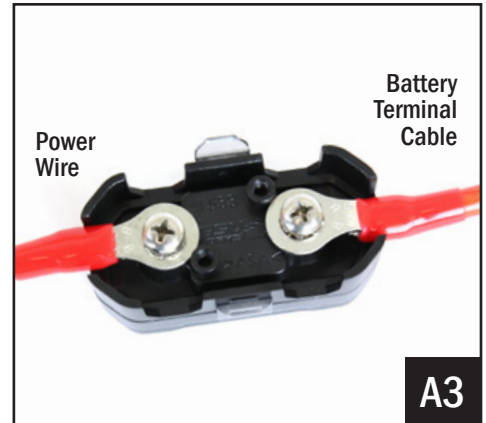

A3. Attach both the Power Wire and Battery Terminal Cable to the fuse holder. Reattach the bottom cover.



B. Unscrew the factory nut on the negative battery terminal. Install the 2 ground cables to the screw on the ground battery terminal. Re-install the factory nut.



C. Unscrew the factory nut on the positive battery terminal. Install the 2 power cables to the screw on the positive battery terminal. Re-install the factory nut.



D. Remove the top of the fuse holder and extract the 2 screws. Insert the 40A fuse, screw the 2 screws back in and reattach the fuse holder top.



E. Zip tie all of the electrical cabling (factory and audio) along the center column away from the drive shaft.

THIS CONCLUDES THE INSTALLATION PROCESS. REPLACE THE FACTORY PANELS AND SEATS. QUESTIONS? PLEASE CONTACT SSV WORKS AT 818-991-1778 OR EMAIL SUPPORT@SSVWORKS.COM

LOOKING FOR MORE SOUND? TRY SSV WORKS CAGE MOUNT 6.5" SPEAKER PODS!

SSV Works custom molded Cage Mount Pods are designed for 6.5" speakers and can be used when you need more sound in your Side by Side. Unlike wakeboard towers, these mini pods are designed to provide sound to the passengers without blocking visibility. They are 100% fiberglass for the best sound quality and bass response. They are finished in a black texture coat to match factory interior textures and can be custom painted to match your color scheme. - Includes the versatility of Axia Alloys patented clamping system and stainless mounting hardware. Even better, they can be loaded with either Kicker or SSV Works powersports 6.5" speakers.



Call **818-991-1778** to order yours today!

Part Number RZ3-C65K

